

## ECCENTRIC BEARING CARRIER INSTALLATION

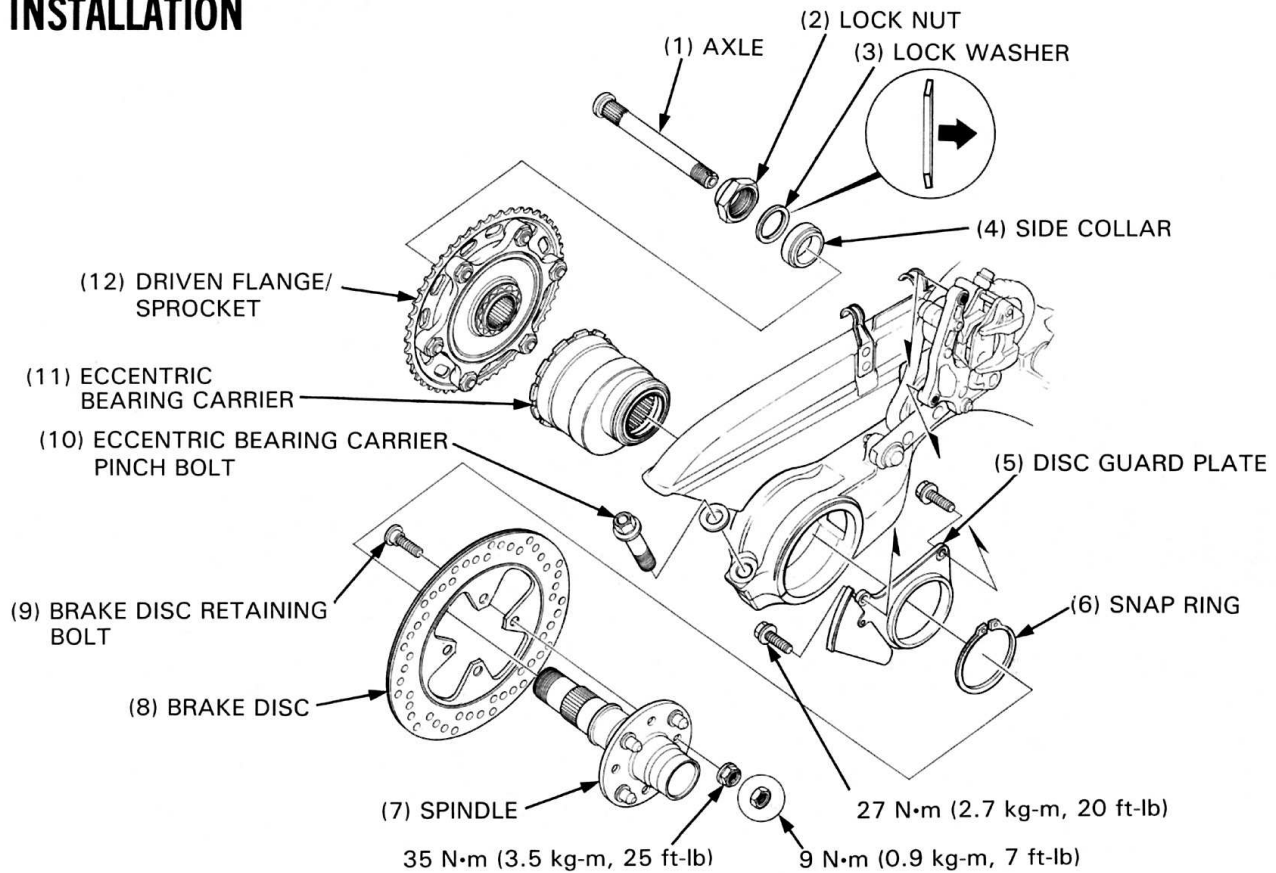

Install the eccentric bearing carrier onto the swingarm. Loosely install the eccentric bearing carrier pinch bolt.

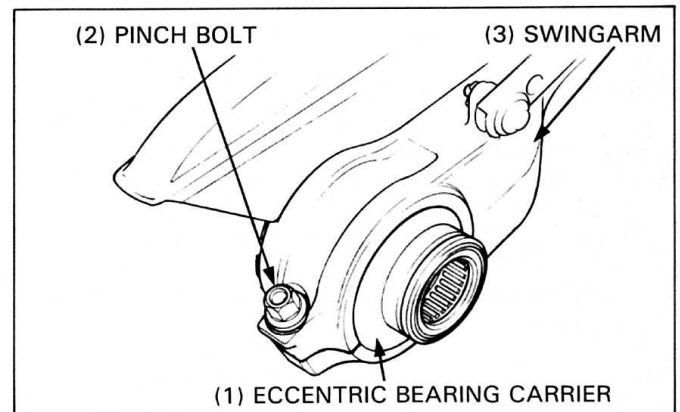

Install the brake disc guard plate onto the eccentric bearing carrier by using the snap ring.

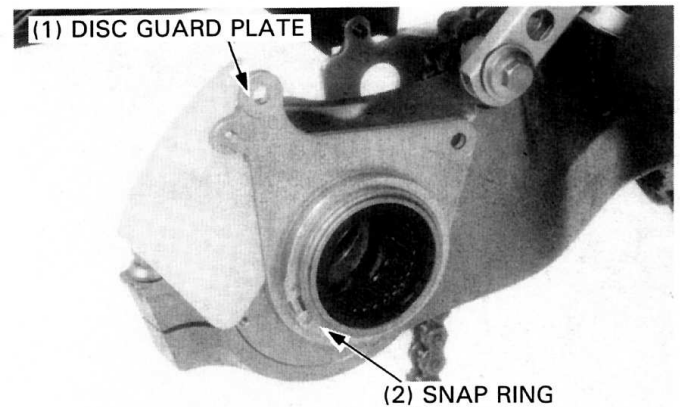

Install the drive chain on the sprocket and position the flange against the eccentric bearing carrier. Insert the spindle through the bearing carrier and driven flange. Engage the driven flange and the spindle, making sure the splines are correctly mated.

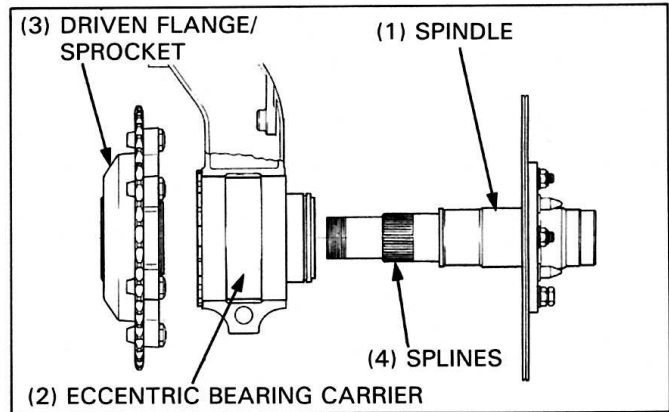

## CAUTION

- Use care not to damage the pads when installing the caliper.

Install over the brake caliper onto the brake disc. Install and tighten the mounting bolts.

**TORQUE: 27 N·m (2.7 kg-m, 20 ft-lb)**

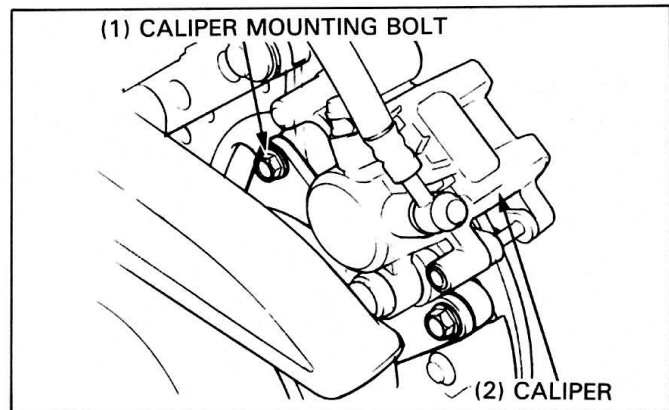

Install the rear axle from the left side.

Install the side collar onto the driven flange.

Install the lock washer onto the spindle as shown.

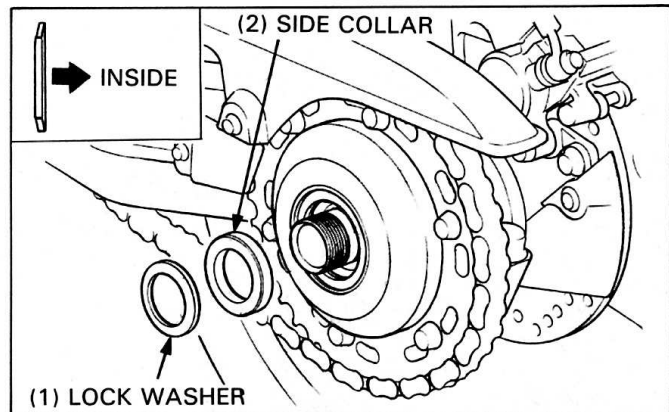

Install the eccentric bearing carrier lock nut and stake it.

**TORQUE: 165 N·m (16.5 kg-m, 120 ft-lb)**

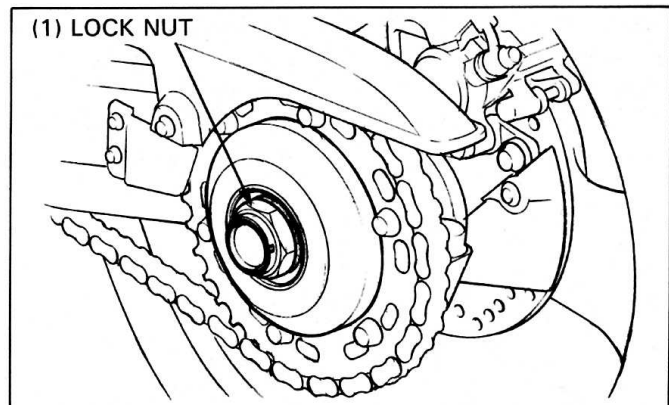

## REAR WHEEL/SUSPENSION

Install the rear wheel (page 13-5).  
Adjust the drive chain slack (page 3-12).

Tighten the eccentric bearing carrier pinch bolt.

**TORQUE: 75 N·m (7.5 kg-m, 54 ft-lb)**

Operate the brake pedal to seat the caliper piston against the pads.

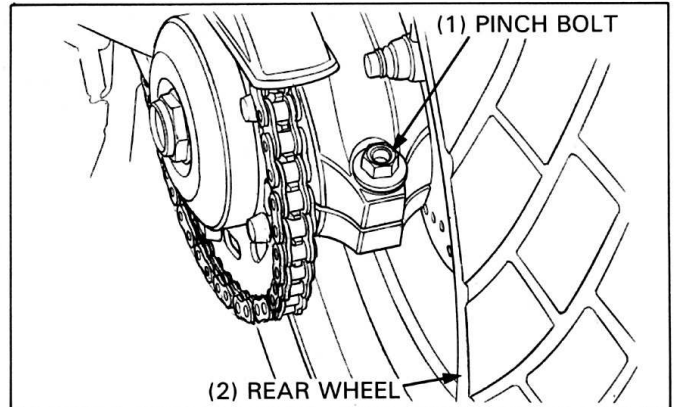

## SHOCK ABSORBER

### ⚠ WARNING

- *The rear shock absorber contains nitrogen under high pressure. Do not allow fire or heat near the shock absorber.*
- *Before disposal of the shock absorber, release the nitrogen.*

### NOTE

- If you plan to disassemble the shock absorber, set the spring adjuster to the softest position at this time.

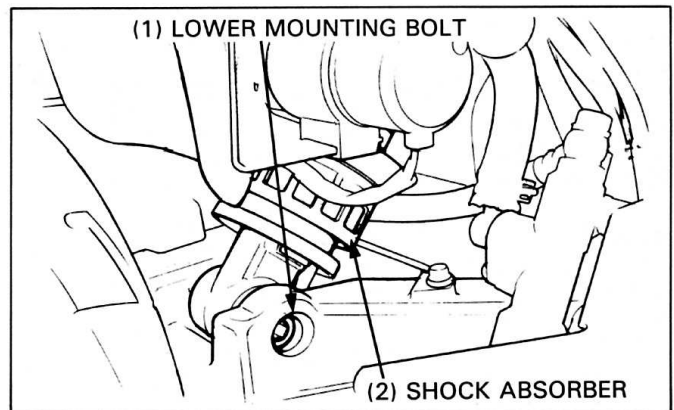

## REMOVAL

Raise the rear wheel off the ground by placing the motorcycle on its center stand.

Remove the seat (page 13-25).  
Remove the shock absorber lower mounting bolt while supporting the wheel.

Remove the following:

- sub-frame upper mounting bolts
- shock absorber upper mounting bolt and nut
- fuel filter base mounting bolt and nut
- fuel filter base

Loosen the sub-frame lower mounting bolts and lower the sub-frame.

Pull the shock absorber out from the frame through the upper sub-frame pipes.

Remove the shock absorber lower mounting collar.

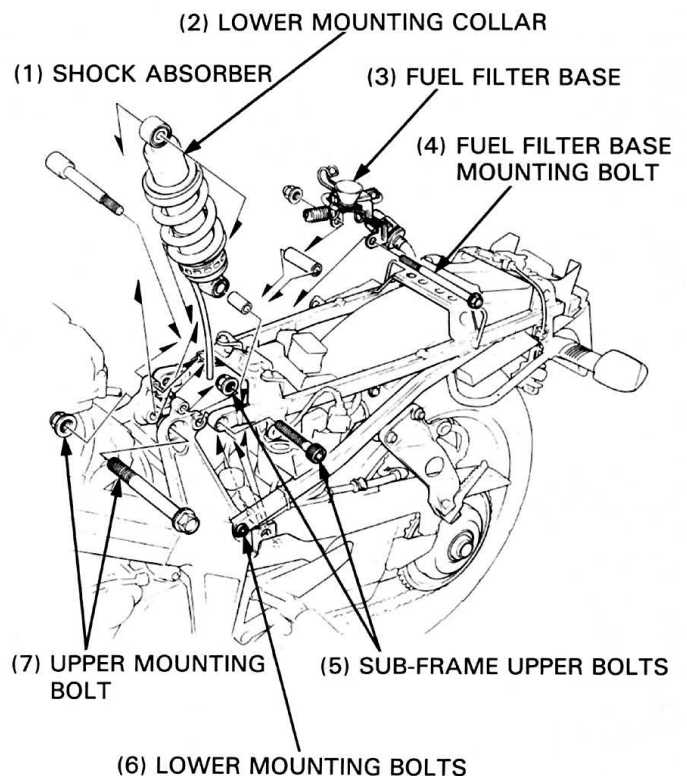

## DISASSEMBLY

Make sure the spring adjuster is set to the softest position before disassembly.  
Set the shock absorber in the hydraulic press with the special tool.

### TOOL:

**Shock absorber compressor attachment 07967—KE10000**

Compress the spring until the stop ring can be removed, and remove the stop ring from the shock absorber.

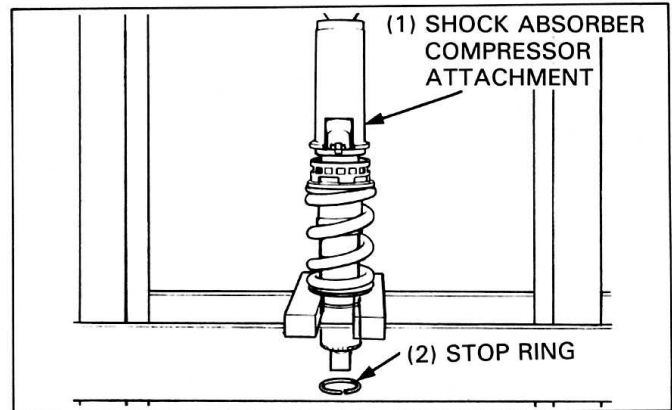

Remove the following:

- upper spring seat
- spring
- lower spring seat
- spring adjuster
- dust seal
- lock nut and lower joint
- stop rubber
- seat

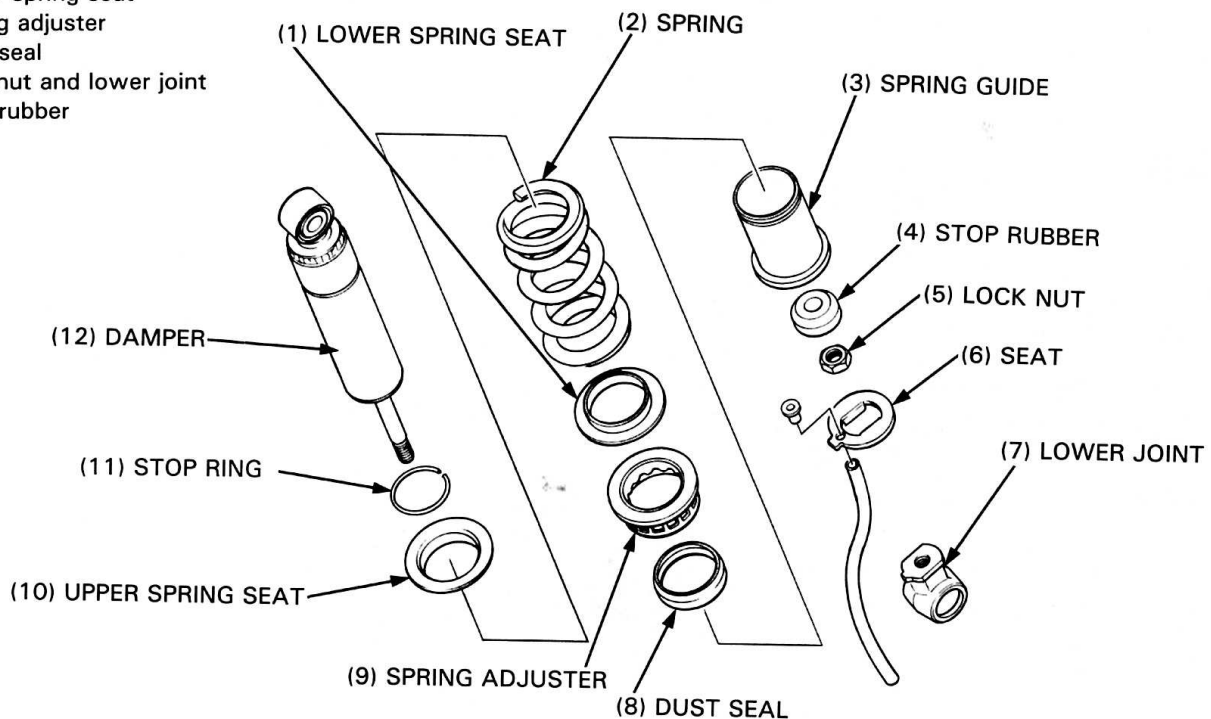

## INSPECTION

Inspect the following parts:

- damper unit for oil leaks
  - damper rod for bends or damage
  - stop rubber for wear or damage
- Inspect all the other parts for wear or damage.

Measure the spring free length.

**SERVICE LIMIT: 148.3 mm (5.84 in)**

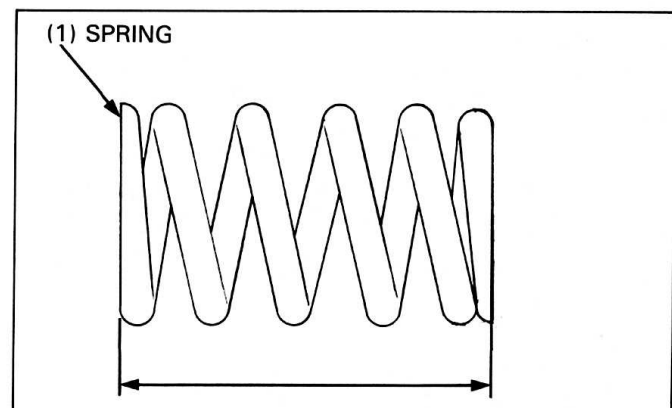

Install the following:

- stop rubber onto the damper rod
- spring guide
- spring adjuster, set to the softest position
- dust seal
- lower spring seat
- spring with the tapered end upward
- upper spring seat

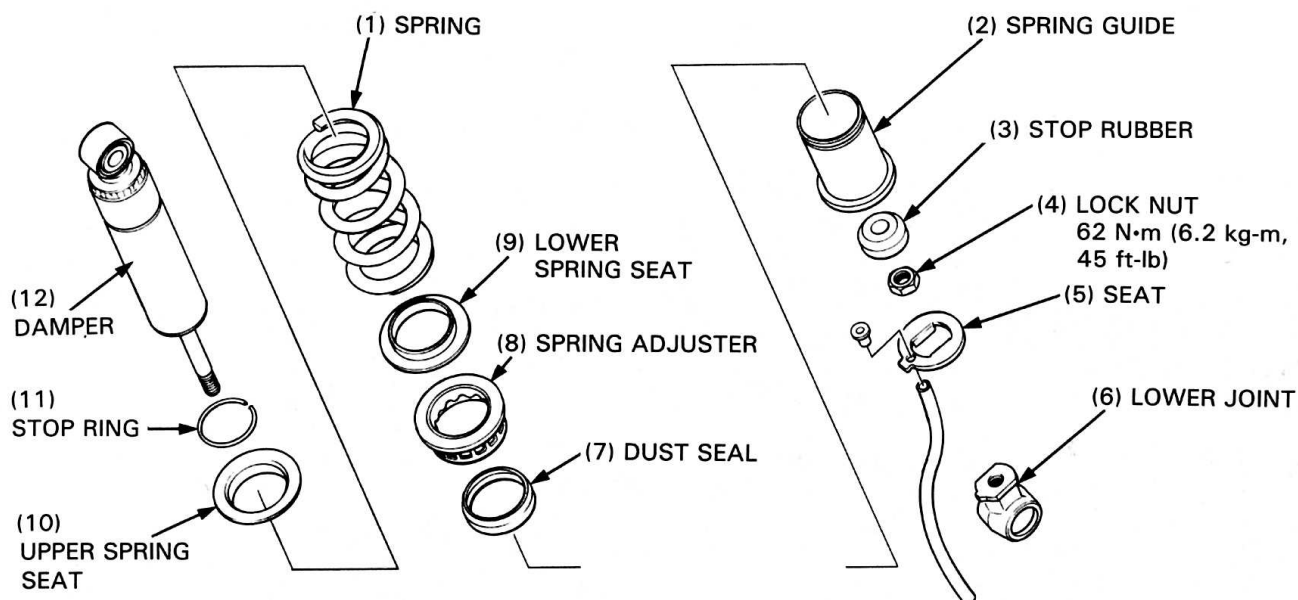

Install the shock absorber drain tube on the seat.

Make sure the tab of the seat is aligned with the groove of the spring guide.

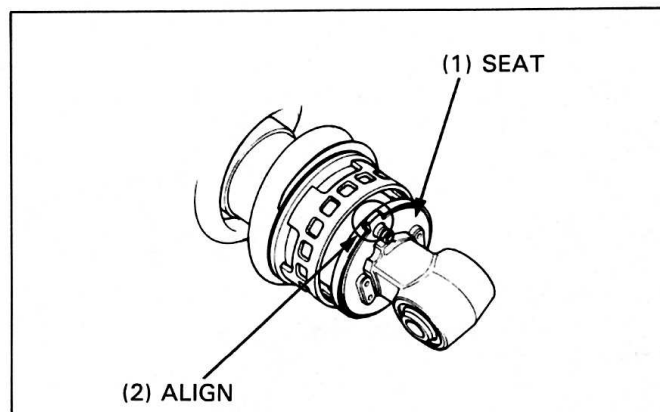

## NOTE

- Make sure the spring adjuster is set to the softest position.

Set the shock absorber in the hydraulic press with the special tool.

## TOOL:

Shock absorber compressor attachment 07967—KE10000

Compress the spring until the stop ring can be installed, and install the stop ring.

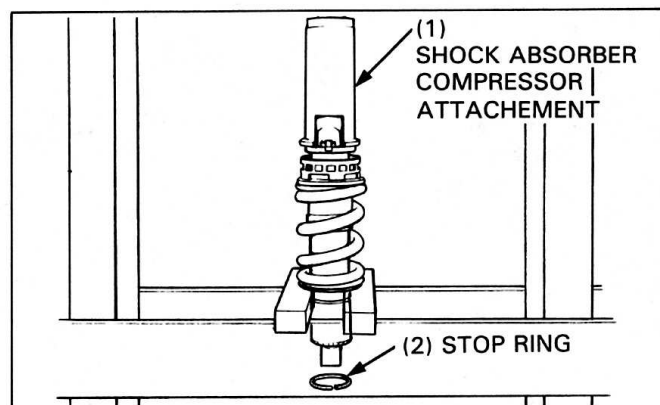

## REAR WHEEL/SUSPENSION

### LOWER MOUNTING BEARING REPLACEMENT

Remove the dust seals from the lower mount.  
Press the needle bearing out of the shock absorber with the special tool.

#### TOOL:

Spherical bearing driver

07946—KA30200

Not available in U.S.A.

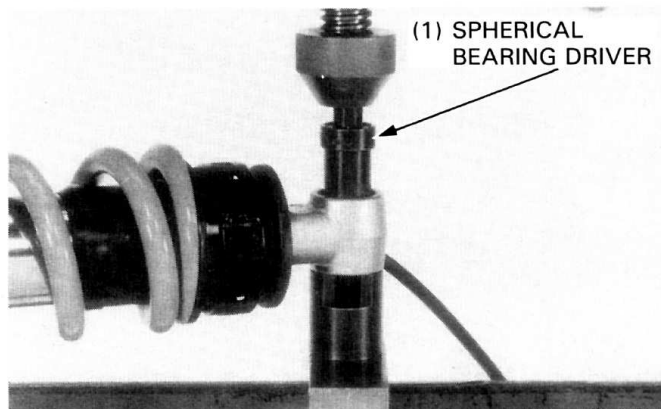

Apply clean grease to a new needle bearing and drive it into the shock absorber until it is flush with lower mount surface.

#### TOOLS:

Driver

07749—0010000

Attachment 24 x 26 mm

07746—0010700

Pilot 17 mm

07746—0040400

Apply clean grease to the dust seal lips and install them onto the lower mount.

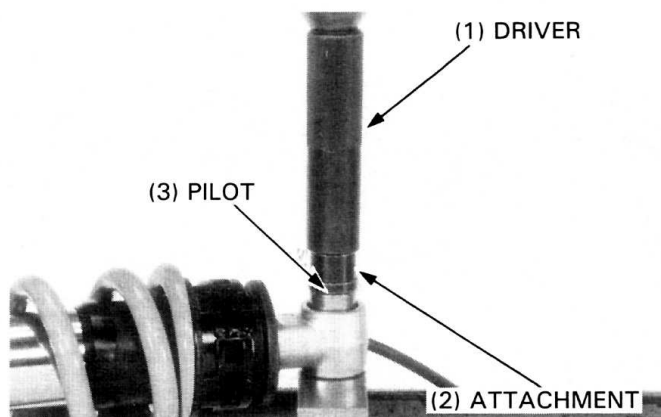

### INSTALLATION

Install the lower mounting collar into the mount.  
Install the shock absorber in the frame with the drain tube facing forward.  
Tighten the shock absorber upper mounting bolt.

**TORQUE: 65 N·m (6.5 kg-m, 47 ft-lb)**

Install the fuel filter base and mounting bolt.

**TORQUE: 22 N·m (2.2 kg-m, 16 ft-lb)**

Install the sub-frame upper mounting bolts.

**TORQUE: 40 N·m (4.0 kg-m, 29 ft-lb)**

Tighten the sub-frame lower mounting bolts.

**TORQUE: 40 N·m (4.0 kg-m, 29 ft-lb)**

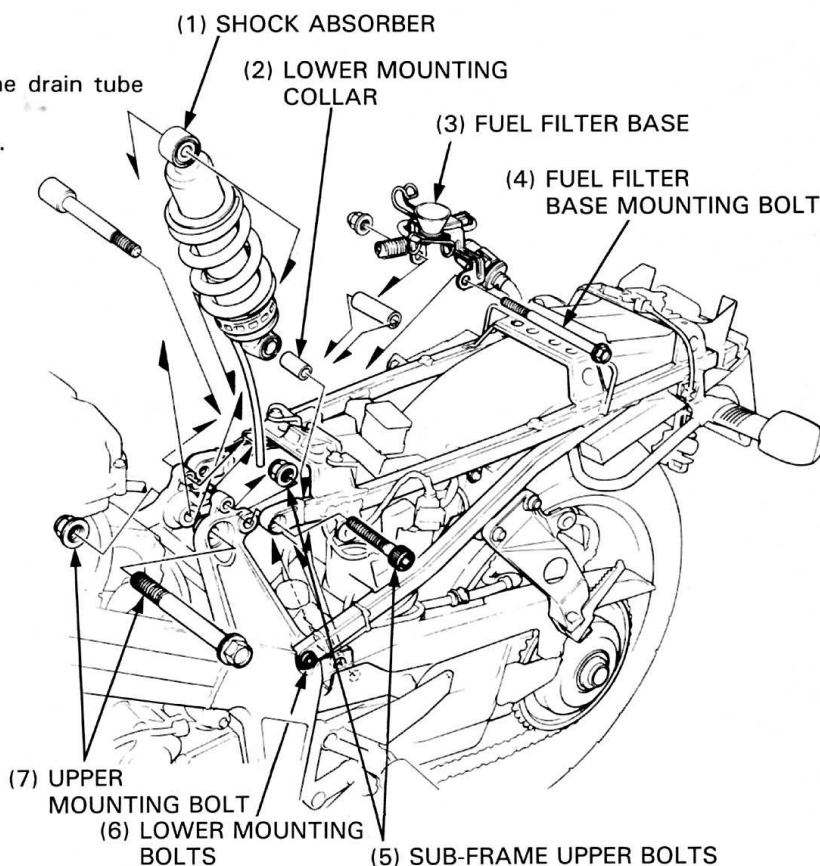

Route and clamp the shock absorber drain tube.  
Install the shock absorber lower mounting bolt.

**TORQUE: 45 N·m (4.5 kg-m, 33 ft-lb)**

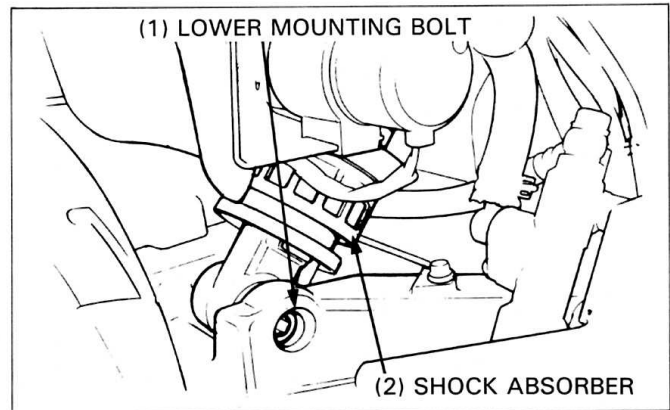

## SWINGARM

### REMOVAL

Raise the rear wheel off the ground by placing the motorcycle on its center stand.  
Remove the rear wheel (page 13-3) and eccentric bearing carrier (page 13-6).

Remove the shock absorber lower mounting bolt.

Remove the swingarm pivot nut.

Unhook the rear brake hose and remove the rear brake caliper (page 14-15).

Loosen the lock nut and remove it.  
Do not pull the swingarm pivot bolt out at this time.

### TOOL:

Lock nut wrench

07908—ME90000

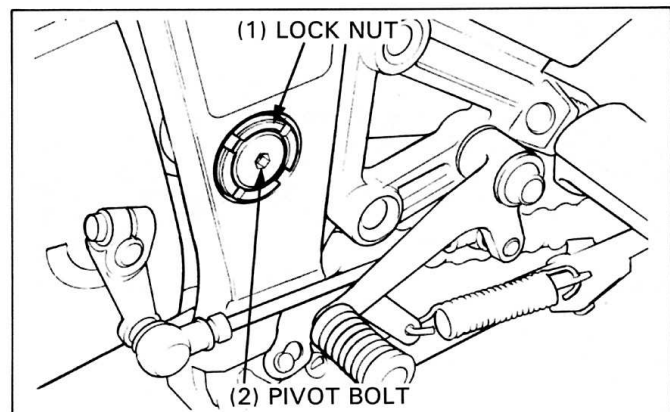
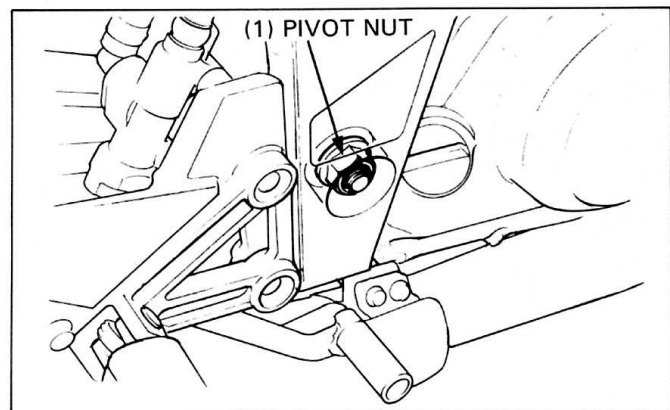

Using a hex wrench, turn the pivot bolt and adjusting bolt counterclockwise together.

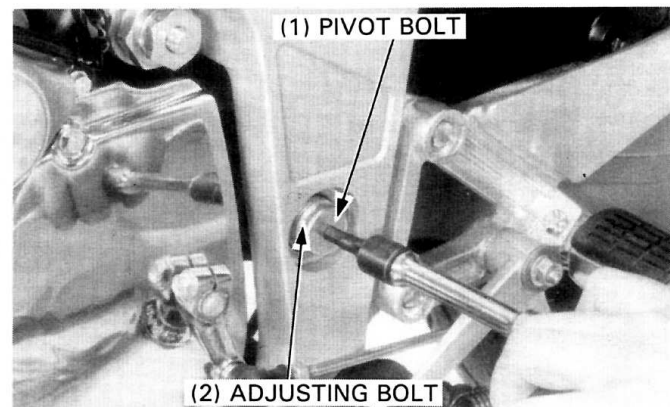



## REAR WHEEL/SUSPENSION

Pull the pivot bolt out the frame while supporting the swing-arm.  
Remove the swingarm from the frame.  
Remove the pivot collars and bushing.

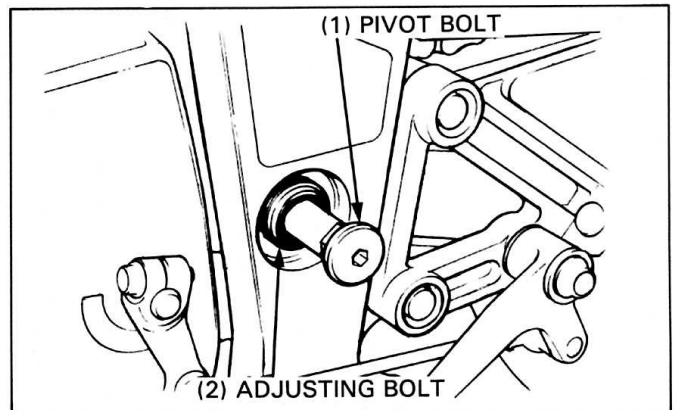

## DISASSEMBLY

Remove the following components:

- drive chain slider
- driven sprocket guard plate
- brake disc guard plate
- brake torque rod
- shock absorber drain tube clamp
- brake hose clamp

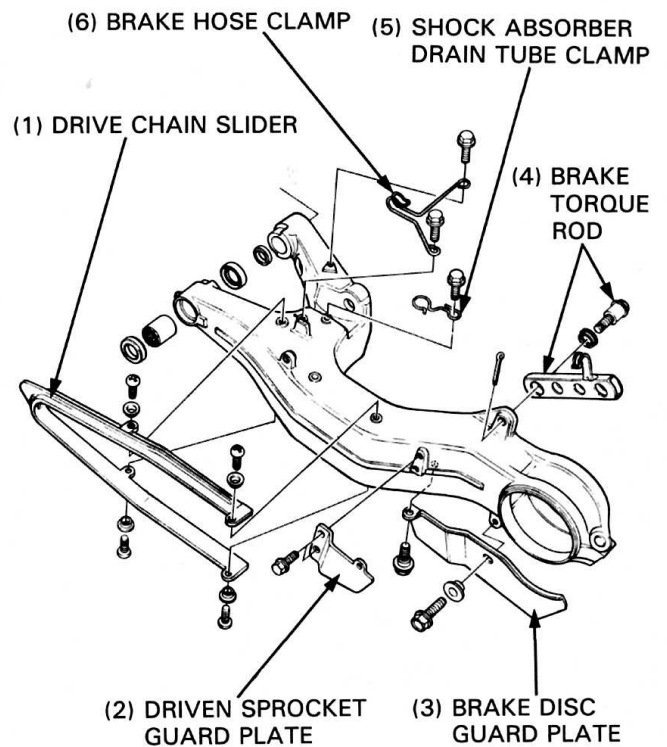

## PIVOT BEARING REPLACEMENT

Remove the dust seals from the swingarm.  
Remove the snap ring from the right side.

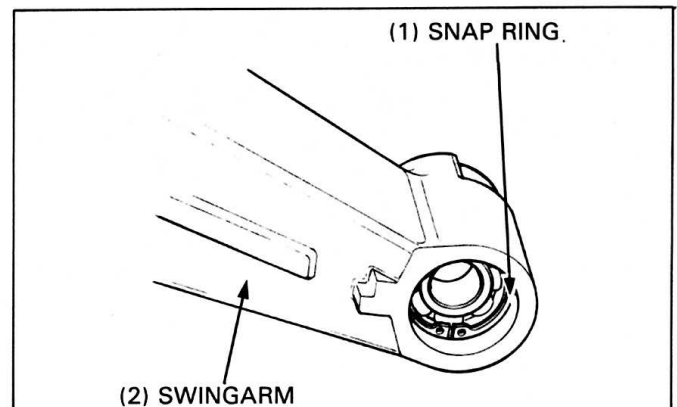



## REAR WHEEL/SUSPENSION

Press the right pivot bearings out of the swingarm using a hydraulic press and the driver shaft.

**TOOL:**

Driver shaft  
Driver handle

07746—MJ00100 or  
07949—3710001

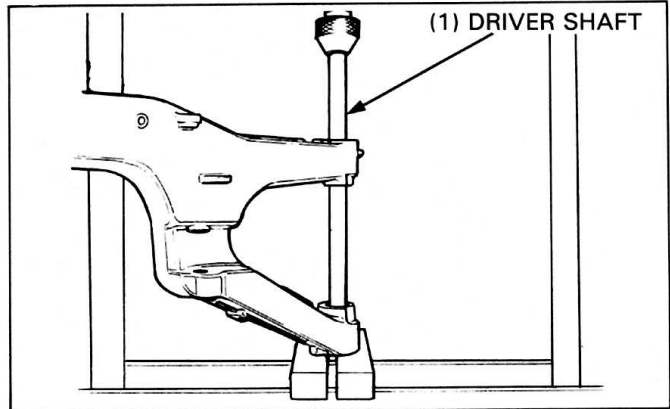

Press the left pivot needle bearing out of the swingarm using a hydraulic press and the special tool.

**TOOL:**

Driver shaft set

07746—MJ00000

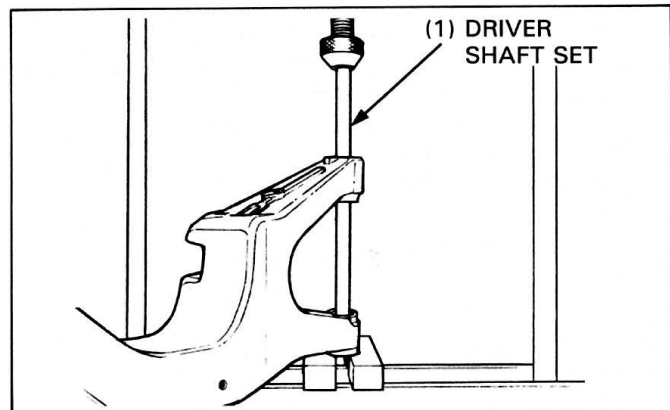

Apply clean grease to the new pivot bearings.  
Press the right pivot bearing into the swingarm until it is flush with the surface.

**TOOLS:**

Driver  
Attachment, 32 x 35 mm  
Pilot, 15 mm

07749—0010000  
07746—0010100  
07746—0040300

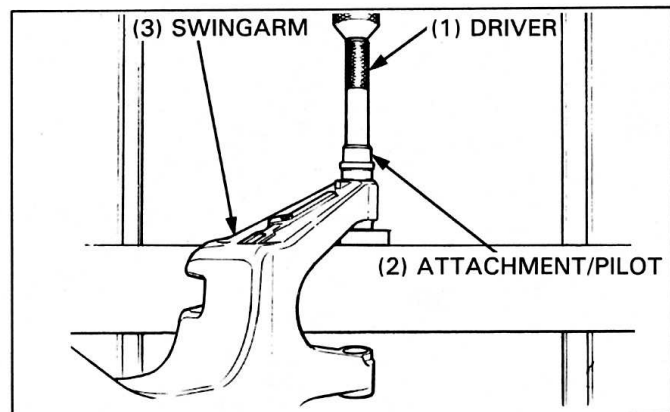

Apply clean grease to the pivot needle bearing.  
Press the left needle pivot bearing into the swingarm until it is flush with the surface.

**TOOLS:**

Driver  
Attachment, 32 x 35 mm  
Pilot, 22 mm

07749—0010000  
07746—0010100  
07746—0041000

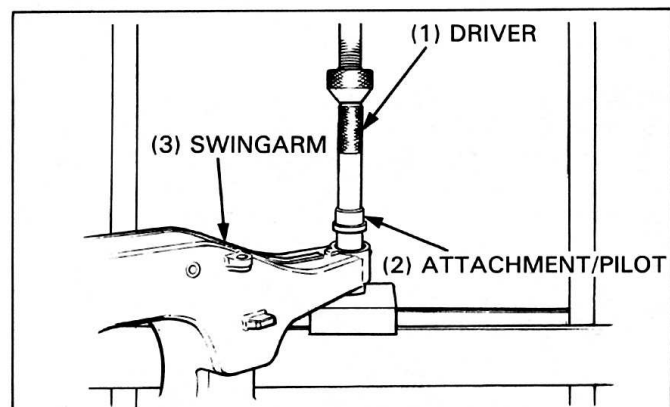

## REAR WHEEL/SUSPENSION

Install the snap ring into the groove in the swingarm.  
Apply clean grease to the dust seal lips and install the dust seals in the swingarm pivots.

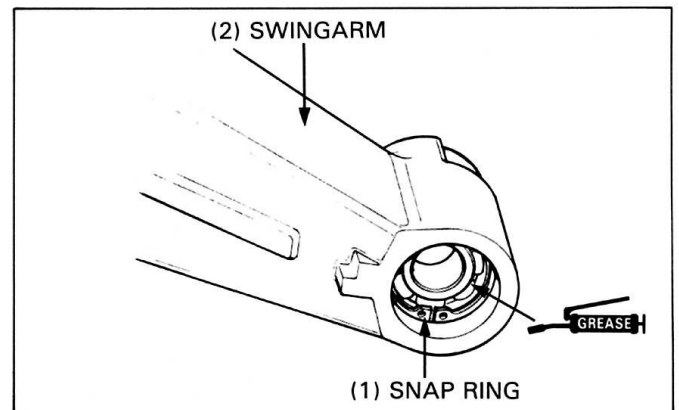

## ASSEMBLY

Install the following components:

- drive chain slider
- driven sprocket guard plate
- brake disc guard plate
- shock absorber drain tube clamp
- brake hose clamp

Install the brake torque rod with a new cotter pin.

**TORQUE: 35 N·m (3.5 kg-m, 25 ft-lb)**

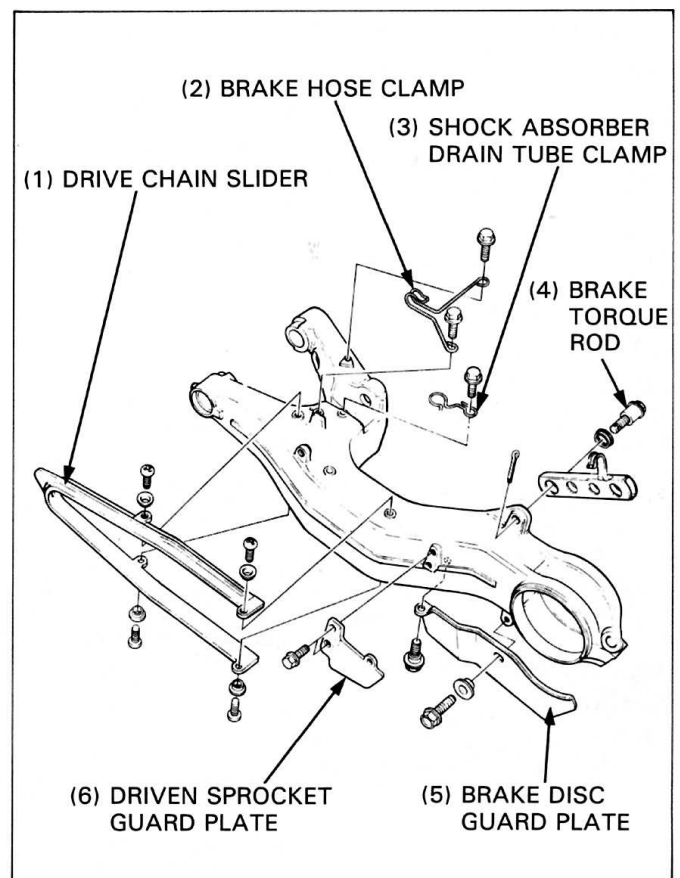

## INSTALLATION

Install the pivot collars and bushing in the swingarm.

Loosely install the pivot adjusting bolt then install the swingarm to the frame.

Insert the pivot bolt through the adjusting bolt fully.

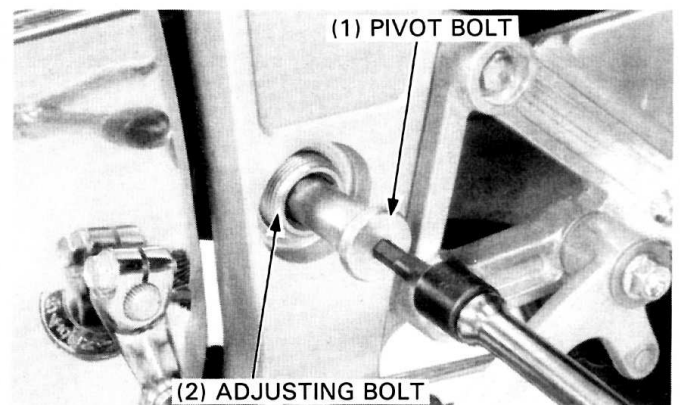

Turn the pivot bolt and adjusting bolt together clockwise until they touch the left pivot collar.  
Tighten the adjusting bolt.

**TORQUE: 15 N·m (1.5 kg-m, 11 ft-lb)**

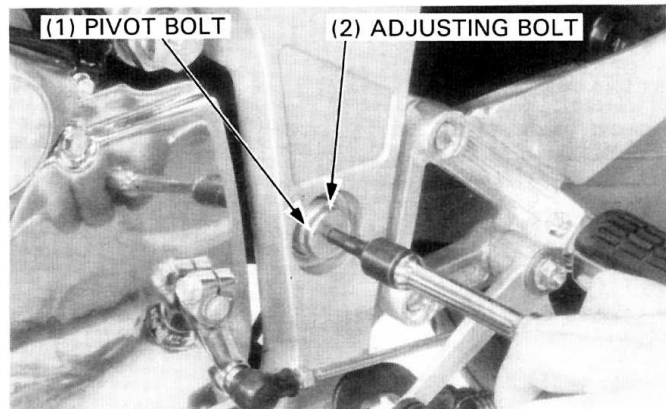

Loosely install the lock nut.  
Tighten the lock nut while holding the adjusting bolt and pivot bolt.

**TORQUE:**

Actual: 65 N·m (6.5 kg-m, 47 ft-lb)

Indicated: 59 N·m (5.9 kg-m, 43 ft-lb)

**TOOL:**

Lock nut wrench

07908—ME90000

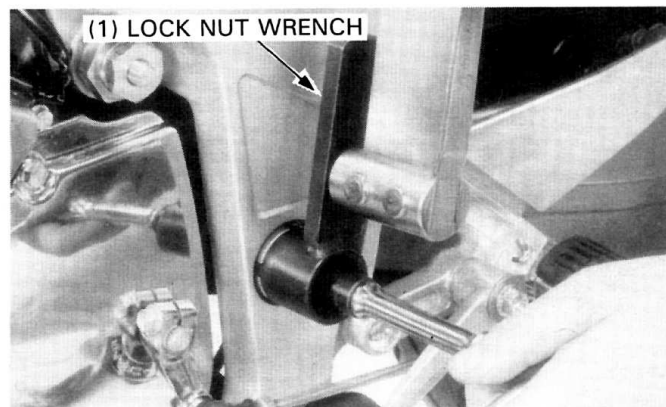

Install the pivot nut and tighten to the specified torque.

**TORQUE: 65 N·m (6.5 kg-m, 47 ft-lb)**

Install the following:

- eccentric bearing carrier (page 13-12).
- rear brake caliper (page 14-17).
- shock absorber lower mounting bolt (page 13-19).
- rear wheel (page 13-5).

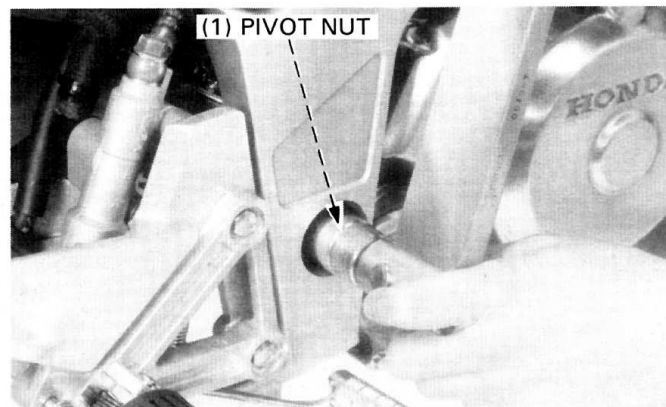

## MUFFLER/EXHAUST PIPE

### REMOVAL

**⚠ WARNING**

- *Do not service the exhaust system while it is hot.*

Remove the following:

- four joint nuts
- two mounting bolts
- exhaust pipe and muffler as assembly.

Loosen the exhaust pipe band bolt and separate the muffler and exhaust pipes.

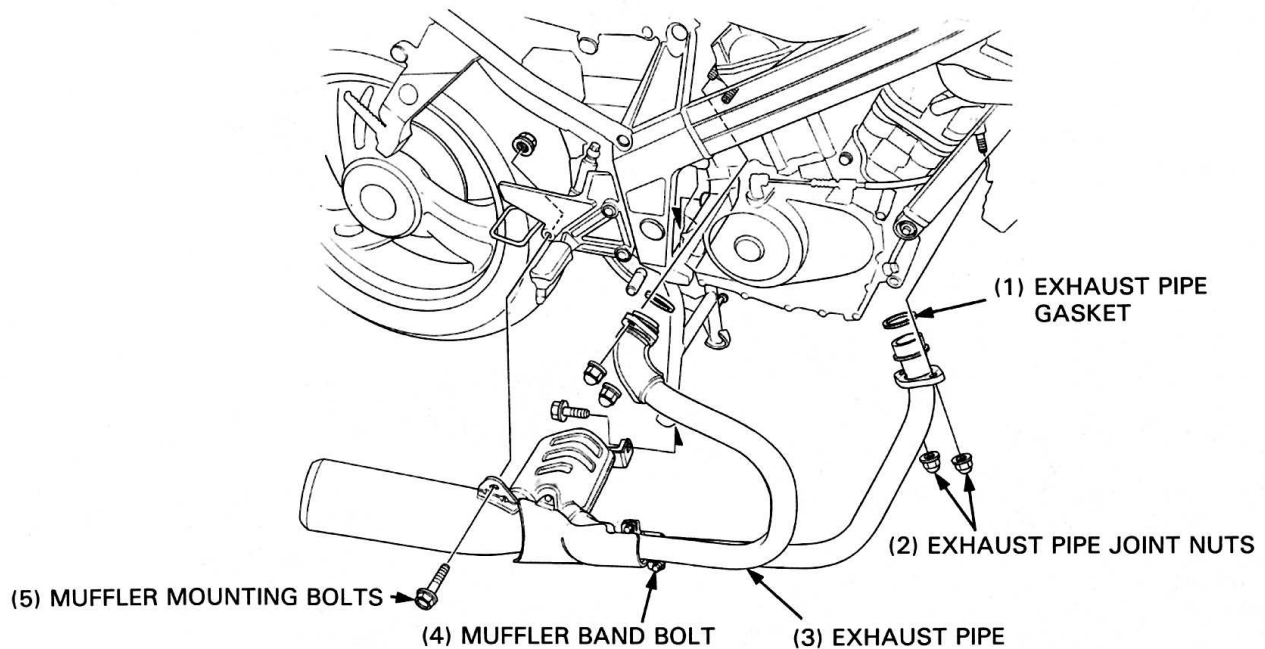

### INSTALLATION

Installation is the reverse order of removal.

Install the exhaust pipe and muffler as an assembly.

**TORQUE:**

- Exhaust pipe joint nut: 27 N·m (2.7 kg-m, 20 ft-lb)
- Muffler mounting bolt: 27 N·m (2.7 kg-m, 20 ft-lb)
- Muffler band bolt: 27 N·m (2.7 kg-m, 20 ft-lb)

**CAUTION**

- *Be sure the new exhaust pipe gaskets are correctly seated on the pipe flange before installing the pipes.*

## SEAT

### REMOVAL/INSTALLATION

Insert the ignition key into the helmet holder and turn it clockwise.

Pull the holder hook down to release the seat lock.

Remove the seat from the frame.

Installation is the reverse order of removal.

#### NOTE

- Apply clean grease to the seat lock striker and latch.

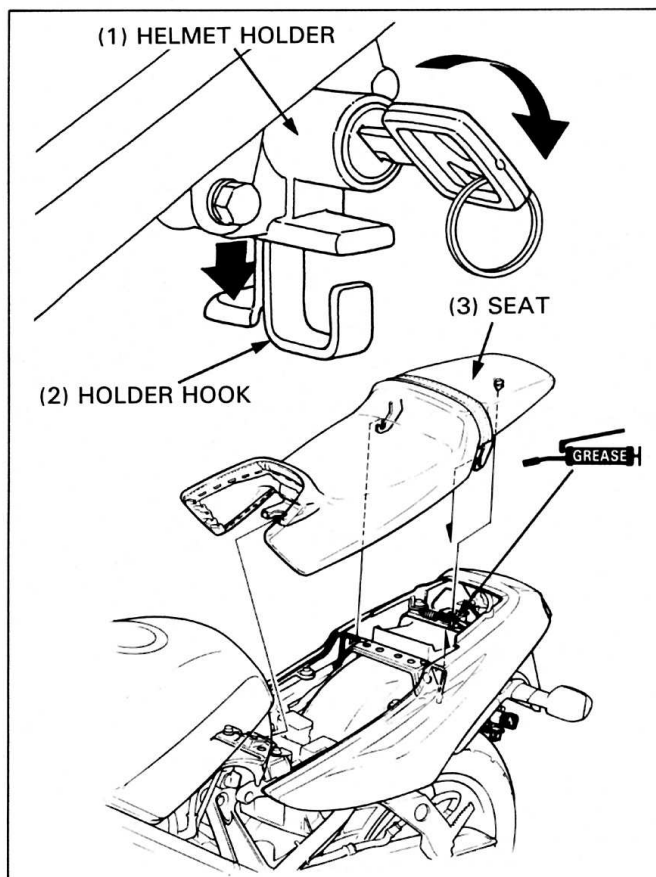

## REAR COWLING

### REMOVAL/INSTALLATION

Remove the seat.

Disconnect the tail/brake and turn signal light wire harnesses connectors.

Remove the four rear cowling mounting bolts and the cowling.

Installation is the reverse order of removal.

